

**BATTERY GREEN**

The Cultural Quarter Project is one of five transformational regeneration projects which received £24.9m from the Government's Towns Fund last year and will see the redevelopment of East Suffolk Council's current Customer Services Centre and the former Battery Green multi-storey car park.

The development will provide:

- 1: a new cultural and community hub with studio space for creative businesses
- 2: A link providing porosity into building and informally connecting spaces within
- 3: A restaurant with flexible/rehearsal space above
- 4: Refurbished Marina Centre for culture and placemaking
- 5: A competitive leisure complex
- 6: landscape enhancements to reinstate the original Battery Green Park

Working closely with East Suffolk Council, the design team comprising Norwich-based architects Chaplin Farrant and Hemingway Design have developed designs in readiness for a planning application to be submitted. The aim of the project is to provide a vibrant hub with innovation and sustainability at its heart; offering leisure, dining and professional opportunities to support an emerging creative sector.

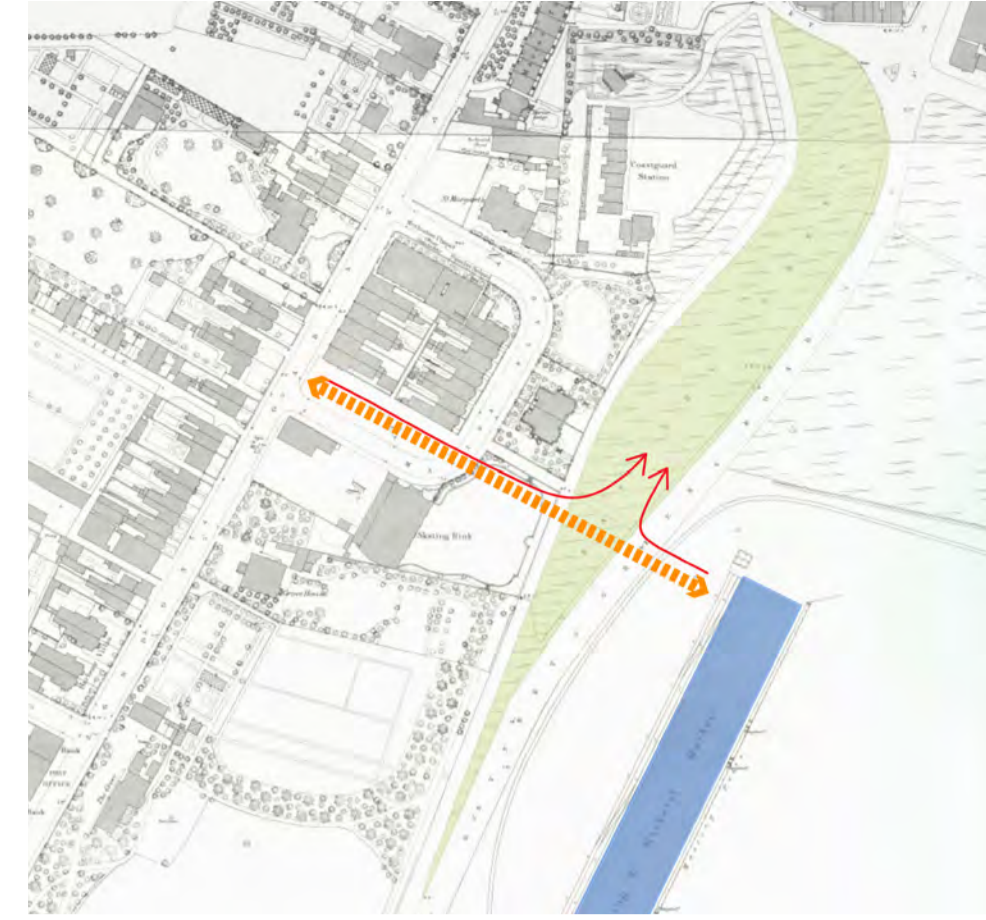

**Historic Map 1840-1890**

- Urban grid designed to create vista towards the port and the fish market.
- Battery Green Park a community focal point at the heart of the town centre.
- Battery Green park easily accessible from both London Road and the port.
- Marina centre site was initially a skating rink (a leisure venue).



Existing Aerial Image



Existing Aerial Image

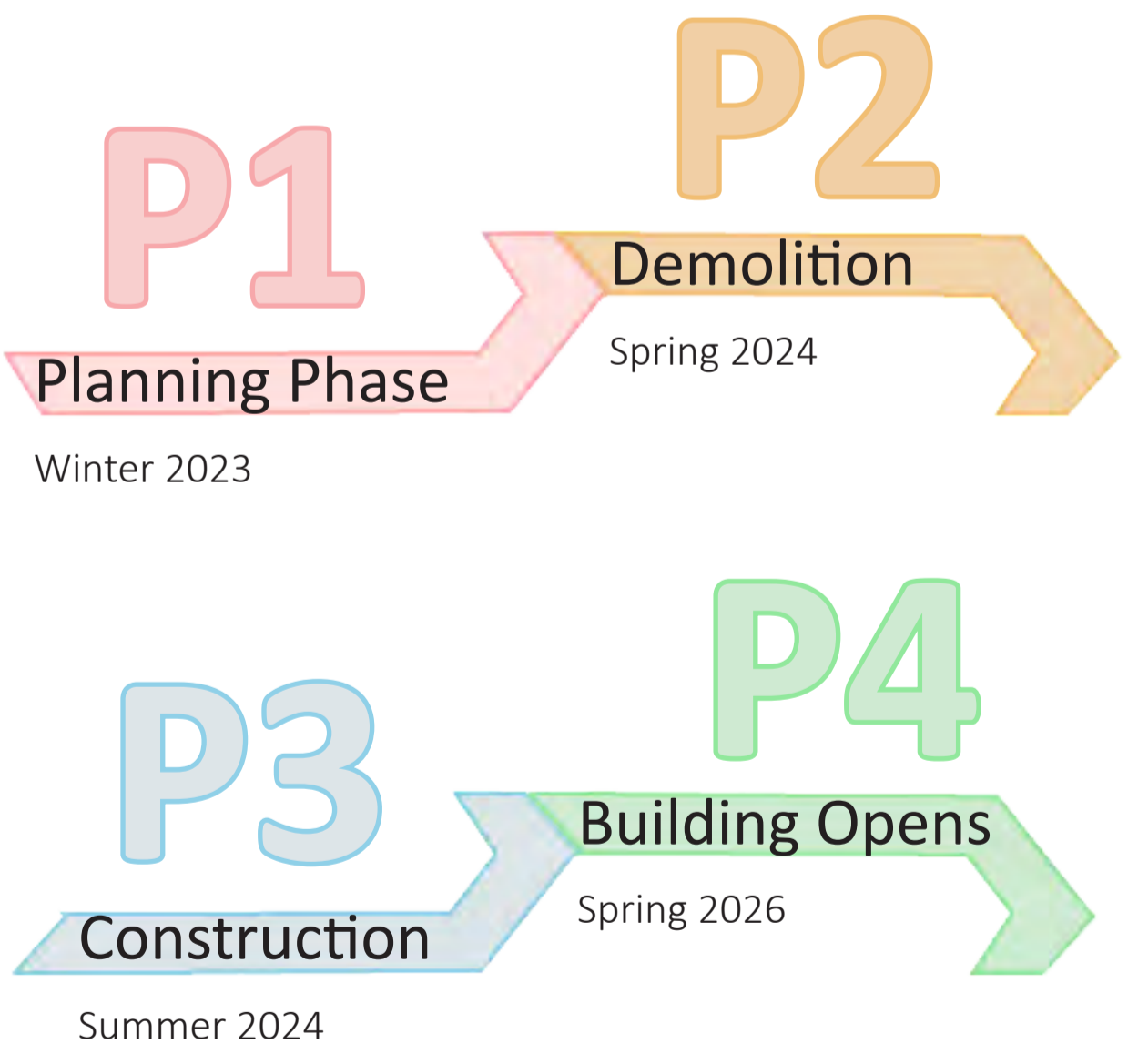
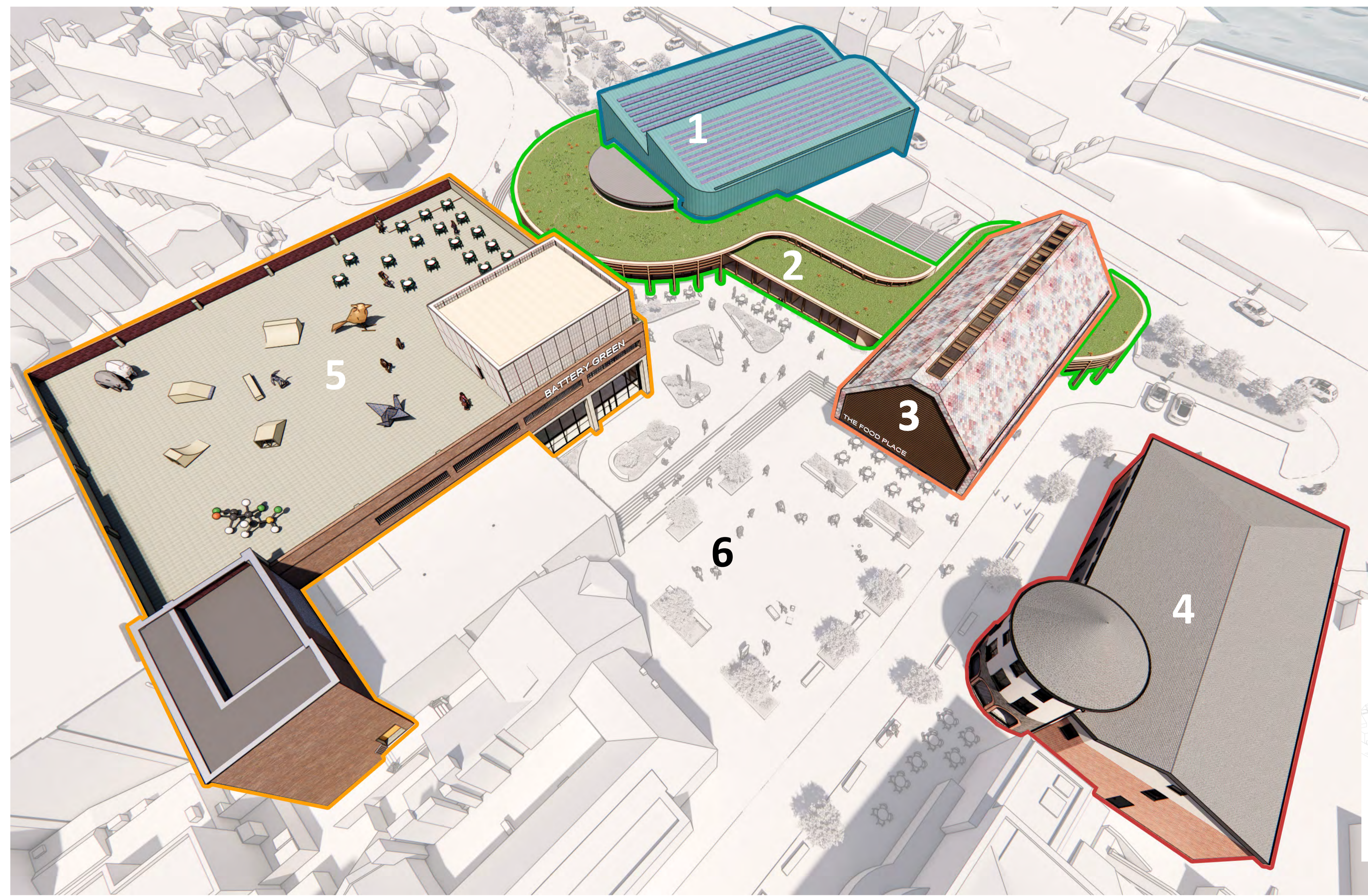

Project Timeline